

MODEL :HUL200

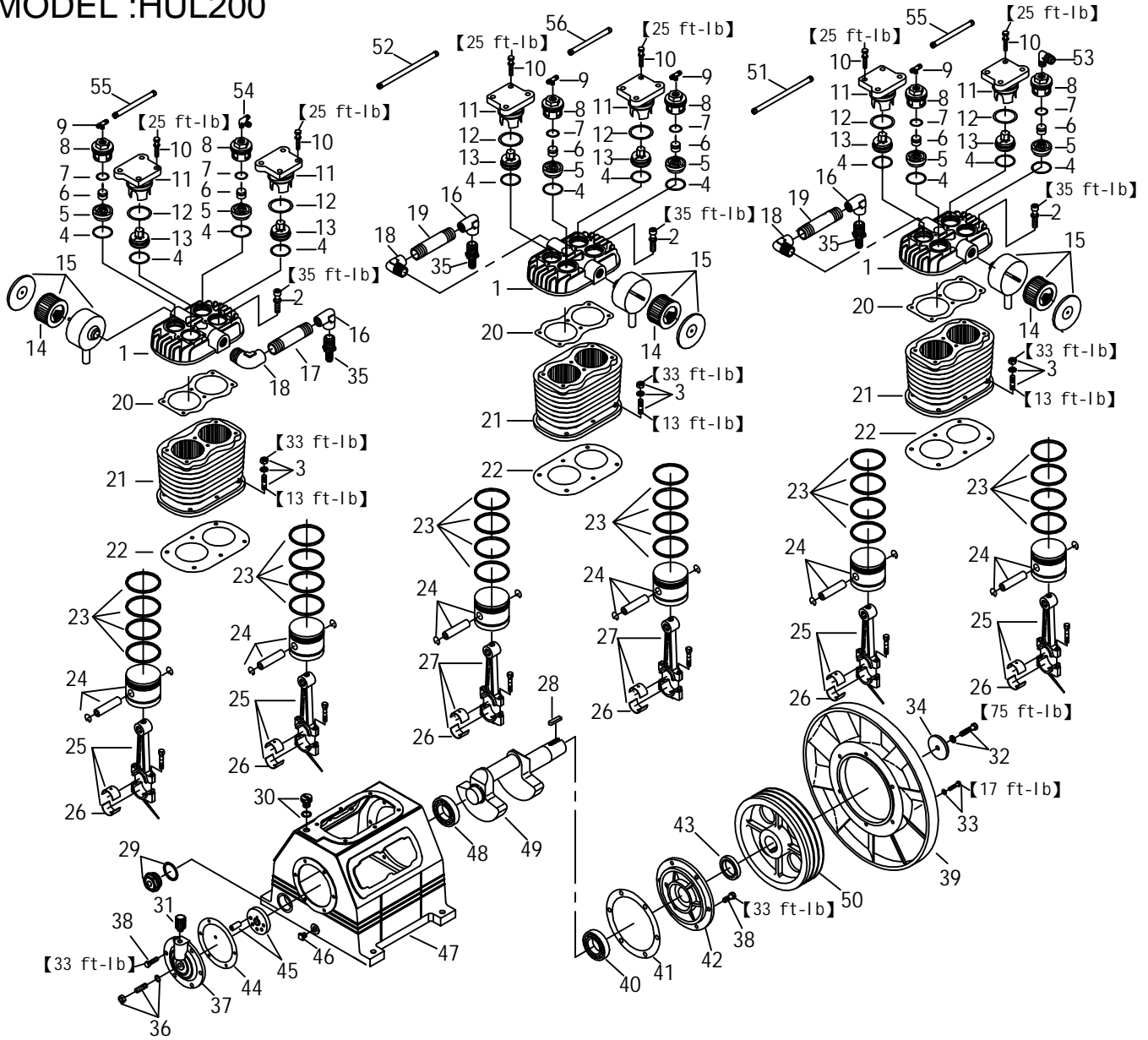

SPARE PARTS LIST

NO : MF-1707

REF. NO.	DESCRIPTION	PART NO.	QTY.	REF. NO.	DESCRIPTION	PART NO.	QTY.
1	Cylinder head	3101053	3	29	Oil sight gauge set	2303024B	1
2	Allen bolt set	3B01-M10*045V	18	30	Oil filling plug set	2319004A	1
3	Double head bolt set	3B11-003-A	18	31	Breathing cover	2321008	1
4	Inlet/Exhaust washer	2B31-002	12	32	Hexagon bolt set	3B00-SM12*050V	1
5	Inlet valve assembly	3B12-PU75	6	33	Hexagon bolt set	3B00-SM08*035AV	6
6	Unloading piston	2113010	6	34	Pulley washer	2B34-13*95*12	1
7	O-ring	2N52-P21V	6	35	Nipple	2N01-049	3
8	Inlet valve holder	3110010	6	36	Bolt set	3B07-SM16*40-A	1
9	Unloading 3-way pipe	2N09-02H01T02H4	4	37	Front bearing seat	3309012	1
10	Hexagon bolt set	3B00-SM08*030V	24	38	Hexagon bolt	2B00-SM10*025	12
11	Exhaust press plate	3126005	6	39	Fly wheel	3PBF-630*280	1
12	O-Ring	2N52-G55V	6	40	Bearing	2N35-32210	1
13	Exhaust valve assembly	3B11-HL75	6	41	Rear bearing seat gasket	2G06-015	1
14	Filter element	2142009	3	42	Rear bearing seat	3311024	1
15	Air filter	2140011	3	43	Oil seal	2N50-TC50*72*12	1
16	Exhaust elbow	2N07-10T10T	3	44	Front bearing seat gasket	2G05-009	1
17	Nipple	2N01-047	1	45	Thrust block set	3312007-A	1
18	Exhaust elbow	2N08-10T10TES	3	46	Oil draining plug	2N33-003	1
19	Nipple	2N01-048	2	47	Crankcase	3301073	1
20	Cylinder head gasket	2G01-019C	3	48	Bearing	2N35-32209	1
21	Cylinder	3201043	3	49	Crankshaft & balancer	3304057-A	1
22	Cylinder gasket	2G04-016	3	50	Pulley	3PBF-138B450	1
23	Piston ring set	3B32-100	6	51	Unloading tube set	3B2-02*680N	1
24	Piston set	3B31-100L	6	52	Unloading tube set	3B2-02*700N	1
25	Rod set	3B33-HL150	4	53	Unloading elbow	2N06-01T02H	1
26	Rod bush(2 pieces)	2316008-B	6	54	Unloading 3-way pipe	2N09-02H01T02H1	1
27	Rod set	3B33-HL150B	2	55	Unloading tube set	3B2-02*220N	2
28	Pulley key	2N47-10*8*40	1	56	Unloading tube set	3B2-02*320N	1