

SPARE PARTS LIST

NO : MP-0803

REF. NO.	DESCRIPTION	PART NO.	QTY	REF. NO.	DESCRIPTION	PART NO.	QTY
1	Cylinder head	31010152	2	16	Bearing	2N35-6205Z	1
2	Allen bolt set	2801-M06*40T	8	17	Rear bearing seat gasket	2C06-008	1
3	In. & Ex. valve assembly	3B13-K5051	2	18	Oil seal	2N50-TC24*47*07	1
4	Double head screw set	2B11-001-A	8	19	Rear bearing seat	3311015	1
5	Cylinder	3201036	2	20	Breathing cover	2321002	1
6	Cylinder gasket	2C04-002	2	21	Hexagon bolt	2B00-SM08*020	4
7	Piston ring set	3B32-51	2	22	Pulley	2B00-SM08*035AV	1
8	Piston set	3B31-51L	2	23	Plate washer	2B30-08*35*35	1
9	Rod set	3B33-H1048	2	24	Hexagon bolt set	2B00-SM08*035AV	1
10	Crankcase	3301014	1	25	Exhaust elbow	2N06-04T04H02T	1
11	Oil draining plug	2N33-001	1	26	Exhaust three way pipe	2N09-04I004T04H1	1
12	Oil sight gauge set	2303014A	1	27	Exhaust tube set	3B2-04*225	1
13	Oil filling plug set	2319003A	1	28	Air filter set	2140019A	2
14	Bearing	2N35-6204	1	29	Filter element	2142013	2
15	Crankshaft & balancer	3304038	1	30	Auto relief valve	2409012	1

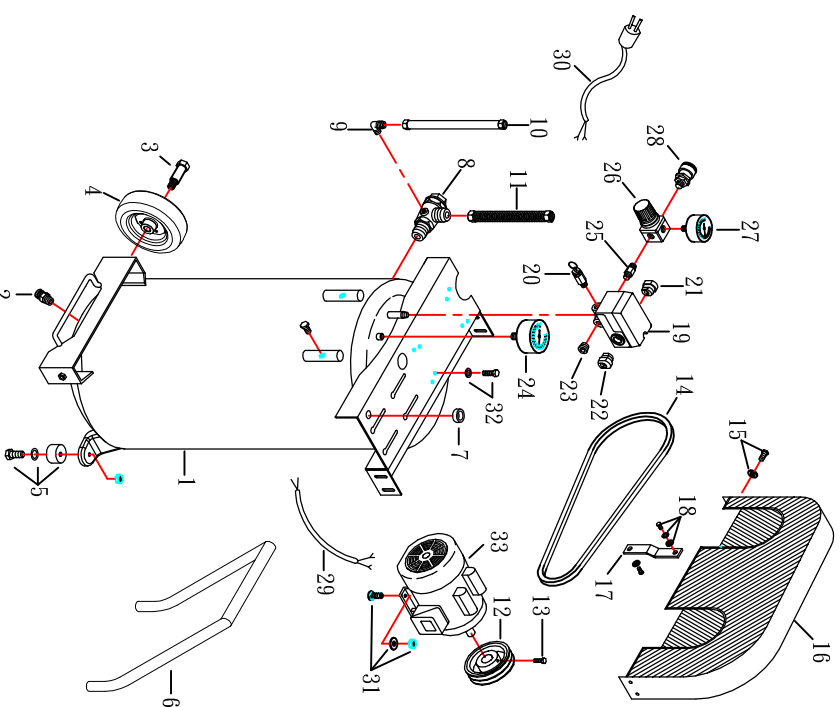

SPARE PARTS LIST

NO : MP-0803

REF. NO.	DESCRIPTION	PART NO.	QTY	REF. NO.	DESCRIPTION	PART NO.	QTY
1	Air tank	3401529C	1	18	Hexagon bolt set	2B00-SM06*020W	1
2	Drain valve	2405011	1	19	Pressure switch	2E21-036T	1
3	Tank wheel bolt	2418005	2	20	Pressure relief valve	2406018T	1
4	Tank wheel	2402032B	2	21	Strain relief bushing	2E04-009	1
5	Rubber pad set	2433013A	2	22	Strain relief bushing	2E04-012	1
6	Grip	3432038-A	1	23	Plug	2B14-ST02E	1
7	Bushing	2E04-101	1	24	Pressure gauge	2D12-2DD14KS	1
8	Check valve	2414025T	1	25	Nipple	2N01-045	1
9	Unloading elbow	2N06-01T02H	1	26	Regulator	24080081NV	1
10	Unloading tube	3B2-02*580T	1	27	Pressure gauge	2D12-15D15KS	1
11	Exhaust tube set	3B2-04*440	1	28	Quick coupler	07MS017_4M-B	1
12	Motor pulley	3PMF-035A1W0515	1	29	Cable	2E02-2030602Y2T	1
13	Hexagon bolt	2B07-SM08*16	1	30	Power cable	2E01-012W	1
14	V-belt	2N31-A43	1	31	Motor feet set bolt	2B08-FM08*20-B	4
15	Hexagon bolt set	2B00-FM08*015W	5	32	Hexagon bolt set	2B00-FM08*025V	4
16	Belt guard	3426056A	1	33	Motor	2M02-A7426	1
17	Bracket	3427043A	1				